

Data Logger FAQ

Commissioning without internet connection

Applicable to: WiNet-S

If there is no internet connection available during commissioning, there is an option to set up the inverter with the iSolarCloud-App in local mode. Please proceed as described in the following pictures.

Choose **More** on the Home screen, select **Local Access** to connect your phone to the WiNet-S. Scan the QR-Code. When you are connected successfully, select **Device Initialization** to commission the inverter.

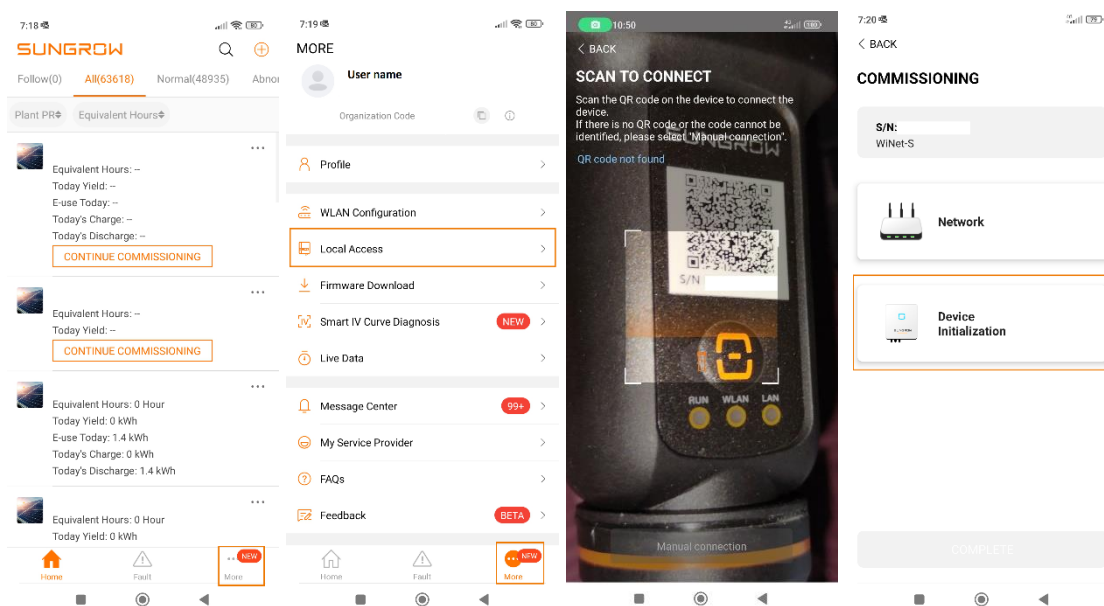

Please note: Make sure, your phone connects to the local WiFi of the WiNet-S instead of the users WiFi during commissioning process.

If you are unable to connect with the WiNet-S via Local Access, try to restart it by disconnecting it for 20 s from the inverter.

If necessary, you can restore factory settings by pressing the button for 5 seconds. Please be aware, if you restore factory settings, all WiFi settings get lost and need to be reconfigured.

Select the **Country /Region**, where the inverter is located and set it up to the local/customer requirements and confirm by choosing **SETTINGS**. Green tick behind Device Initialization indicates, that settings were set successfully.

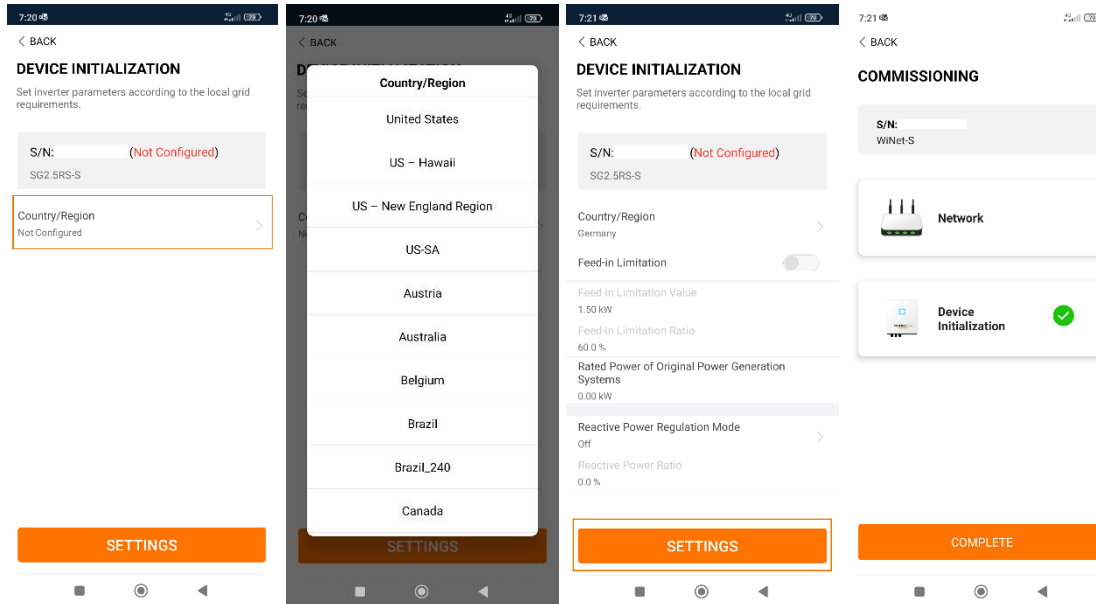

If you want to connect the plant via WiFi to the internet at a later stage, choose **WLAN Configuration** in the **More** -menu. Select your local WiFi and insert the password. When your changes were successful, two green ticks will appear at Network Status and Server Connection Status in local mode.

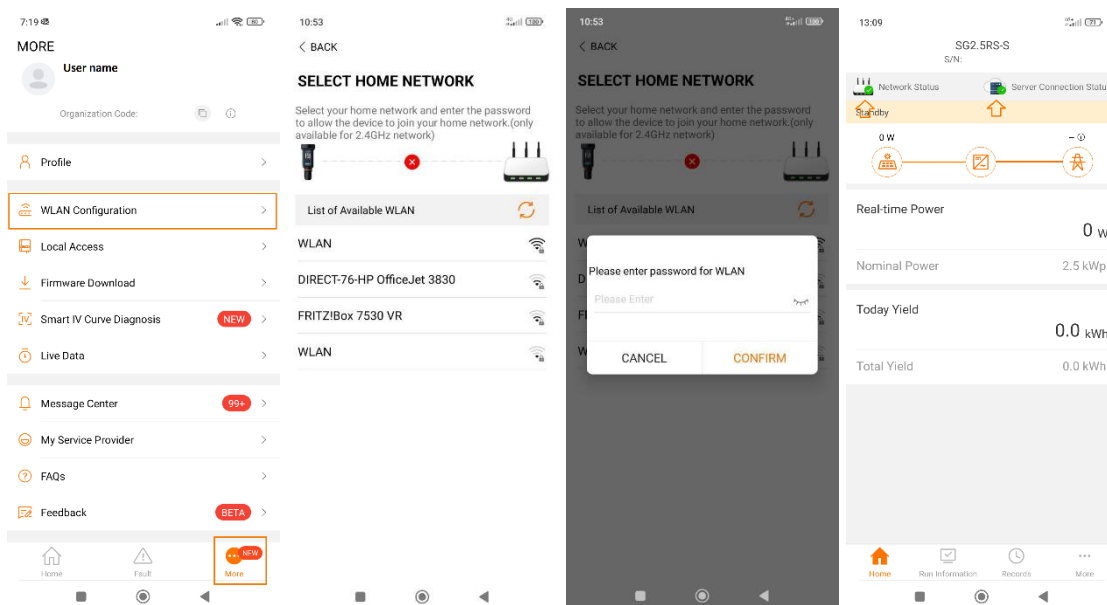

For further information, please download the user manual [here](#).



iSolarCloud App

This manual is intended for professional technicians who are responsible for installation, operation, maintenance and troubleshooting of inverters, and users who need to check inverter parameters. The inverter must only be installed by professional technicians.

The professional technician is required to meet the following requirements:

- Know electronic, electrical wiring and mechanical expertise, and be familiar with electrical and mechanical schematics.
- Have received professional training related to the installation, commissioning and troubleshooting of electrical equipment.
- Be able to quickly respond to hazards or emergencies that occur during installation, commissioning and troubleshooting.
- Be familiar with local standards and relevant safety regulations of electrical systems.
- Read this manual thoroughly and understand the safety instructions related to operations.