

Data Logger FAQ

How to exchange WiNet-S in iSolarCloud-App

Applicable to: WiNet-S

To exchange the SUNGROW Winet-S, please proceed as followed.

1. Open iSolarCloud App on your mobile device and open the plant overview.

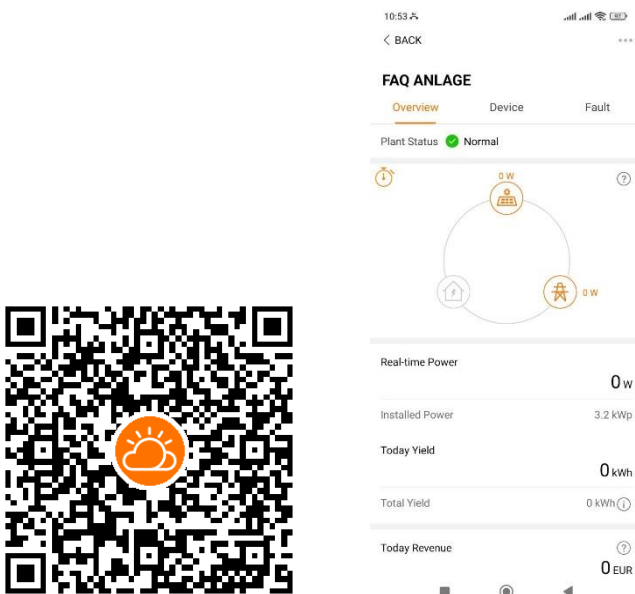

2. Select **Device** and click on the three dots next to the WiNet-S, which you want to exchange. Click on **Device Replacement** to replace it with a new one. **Continue** on the next page, if you ensured the mentioned points.

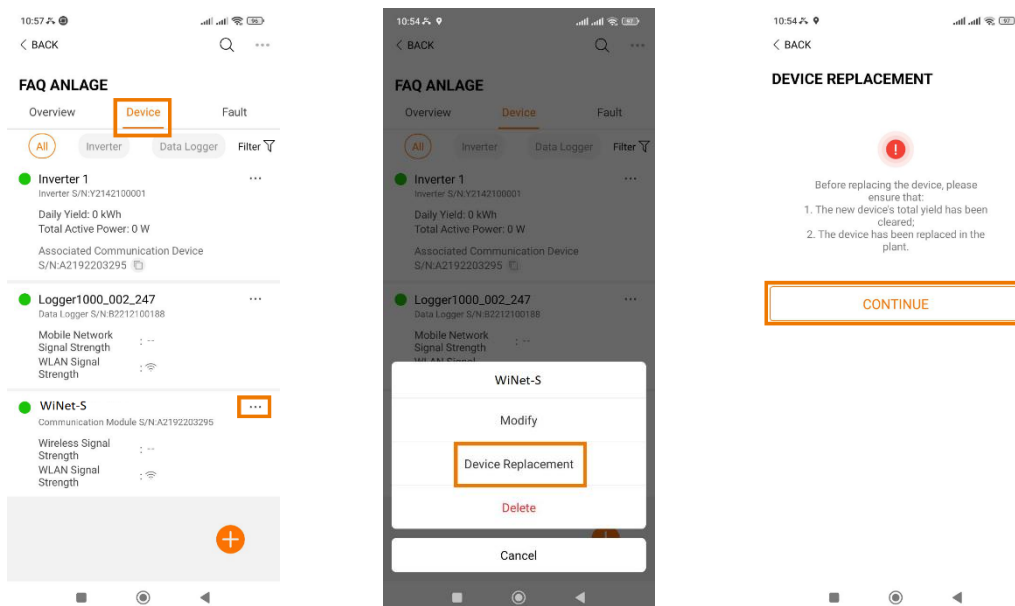

- Press **+** to add the new device's serial number either by typing it in or scanning the QR-Code on the front of the new WiNet-S. Click **START REPLACEMENT**, when serial number is correct.

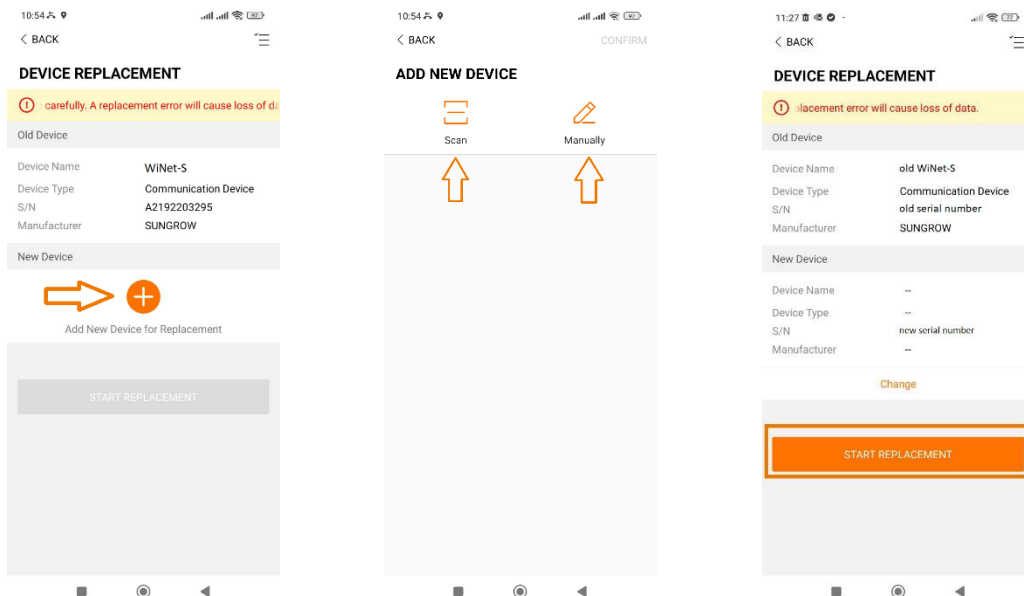

The device is replaced correctly when you find it marked green in the **Device** list.

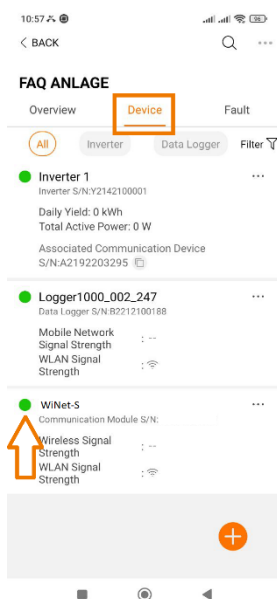

For further information, please download the user manual [here](#).

This manual is intended for professional technicians who are responsible for installation, operation, maintenance and troubleshooting of inverters, and users who need to check inverter parameters. The inverter must only be installed by professional technicians.

The professional technician is required to meet the following requirements:

- Know electronic, electrical wiring and mechanical expertise, and be familiar with electrical and mechanical schematics.
- Have received professional training related to the installation, commissioning and troubleshooting of electrical equipment.
- Be able to quickly respond to hazards or emergencies that occur during installation, commissioning and troubleshooting.
- Be familiar with local standards and relevant safety regulations of electrical systems.
- Read this manual thoroughly and understand the safety instructions related to operations.