

Data Logger FAQ

How to replace the WiFi-Adapter with a WiNet-S

Applicable to: WiNet-S

The new Sungrow inverters all come with a WiNet-S communication adapter. In order to achieve 10-second refresh rate for Live-data in an older plant which was commissioned with WiFi adapter, the WiFi adapter must be replaced with a WiNet-S.

The following process describes step by step how to replace the device.

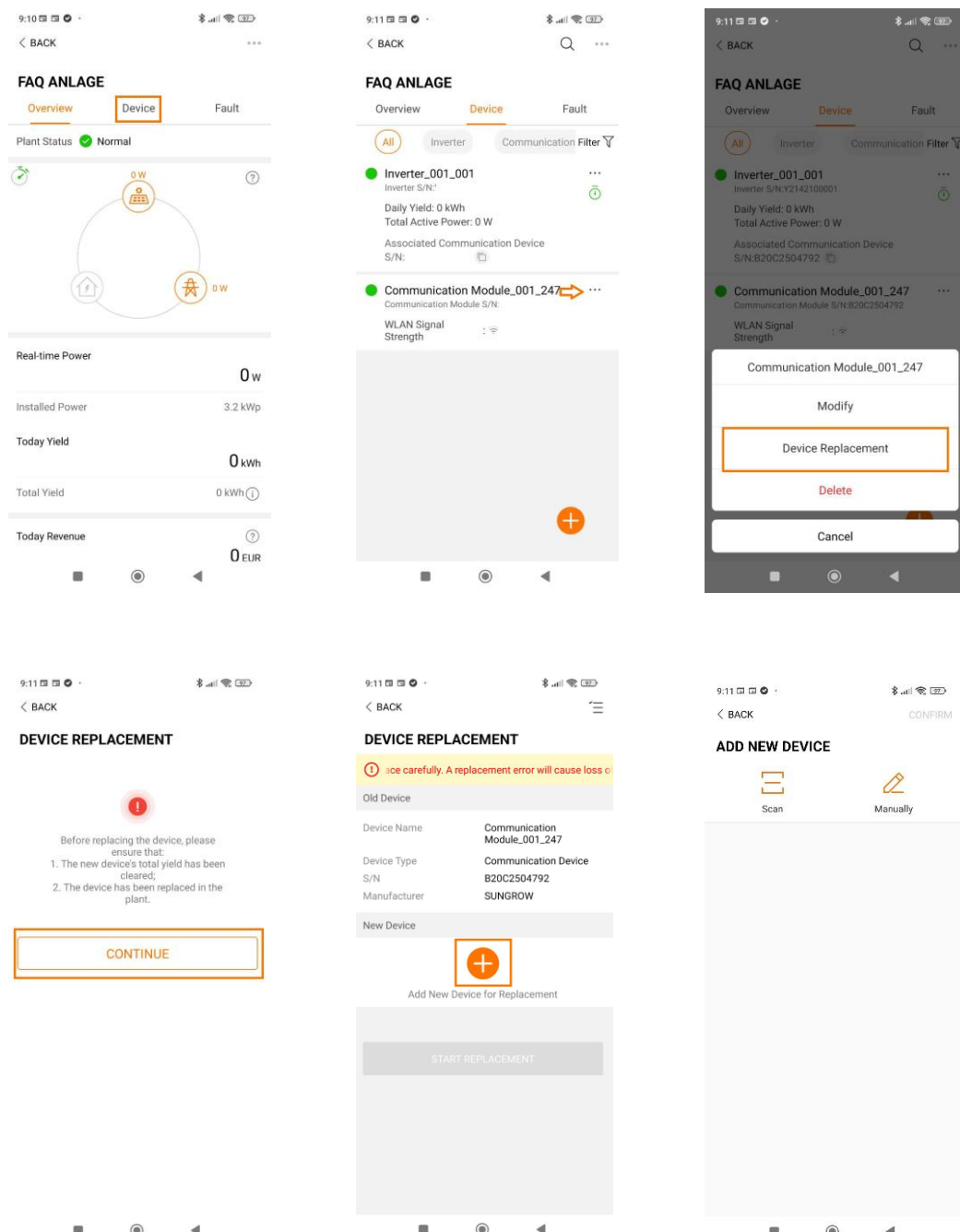

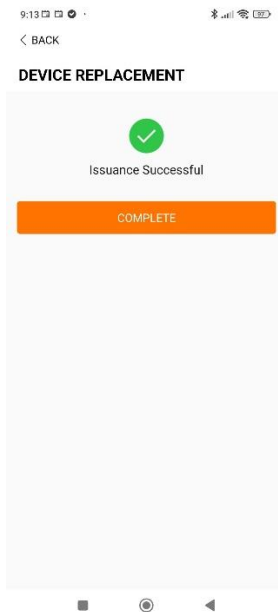
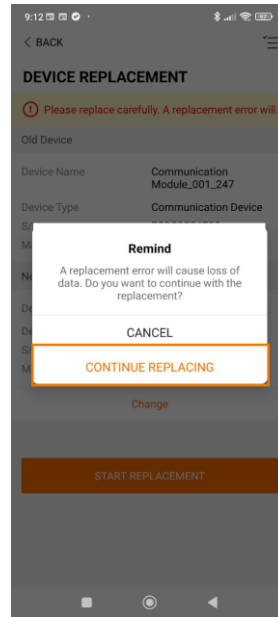
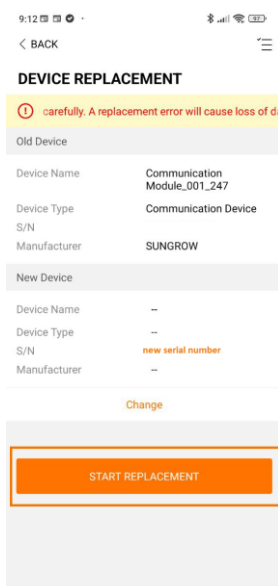

In order to finalize the Device replacement process, you need to connect to Local Access Mode to connect the new WiNet-S to the Wifi network. Press the orange Local Access button and scan the new WiNet-S again.

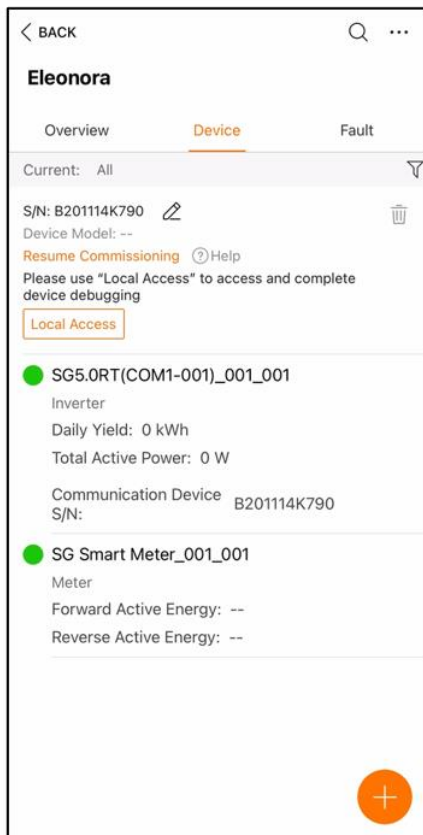

Please press three times the button on the WiNet-S to create a Wifi hotspot and connect your phone to the Wifi hotspot of the WiNet-S (the name starts with SG...) for newer versions of iSolarCloud this will happen automatically and you just need to press **Join** on the popup window.

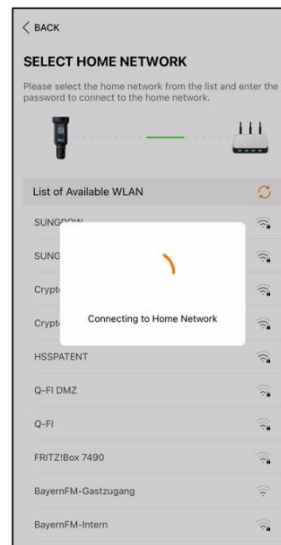
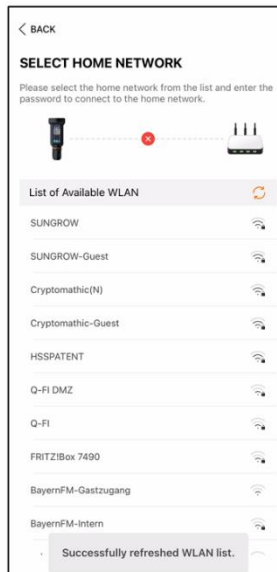
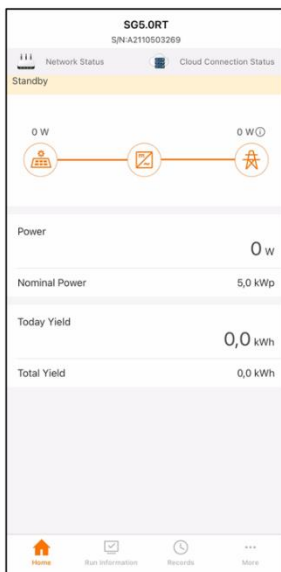
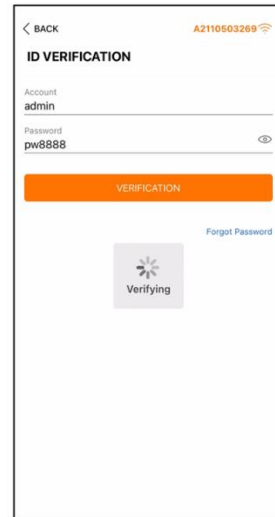
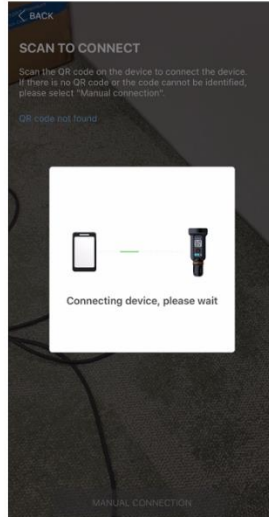
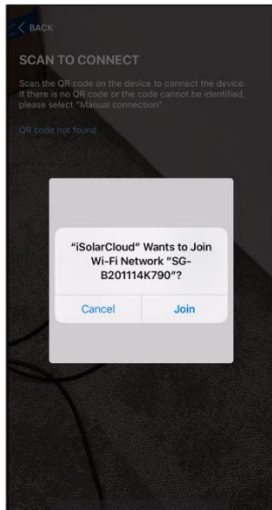

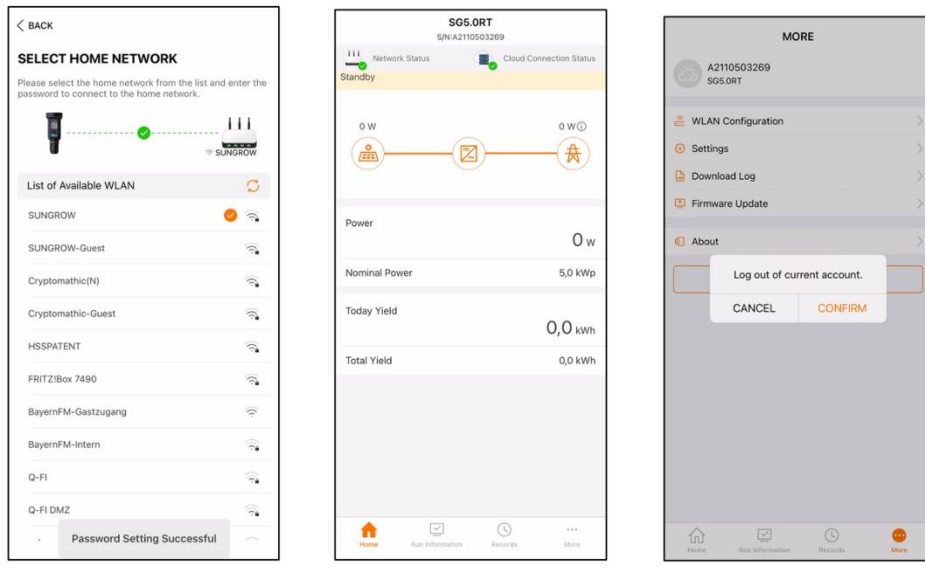

Please be aware, that the following inverters are **not** compatible with WiNet-S:

- SG125HV
- SG125HX
- SG250HX

For further information, please download the user manual [here](#).

This manual is intended for professional technicians who are responsible for installation, operation, maintenance and troubleshooting of inverters, and users who need to check inverter parameters. The inverter must only be installed by professional technicians.

The professional technician is required to meet the following requirements:

- Know electronic, electrical wiring and mechanical expertise, and be familiar with electrical and mechanical schematics.
- Have received professional training related to the installation, commissioning and troubleshooting of electrical equipment.
- Be able to quickly respond to hazards or emergencies that occur during installation, commissioning and troubleshooting.
- Be familiar with local standards and relevant safety regulations of electrical systems.
- Read this manual thoroughly and understand the safety instructions related to operations.