

## Data Logger FAQ

# How to activate Live Data permanently

Applicable to: Data Loggers

In order to activate Live data permanently, select the plant and choose the data logger/communication module on iSolarCloud. Please be aware that all communication devices must be updated to the latest firmware.

On the Web browser version, go to **Settings**, select **Communication Module/Data Logger**. Tick the box close to the selected communication module/datalogger and then click **Common Parameter Settings**.

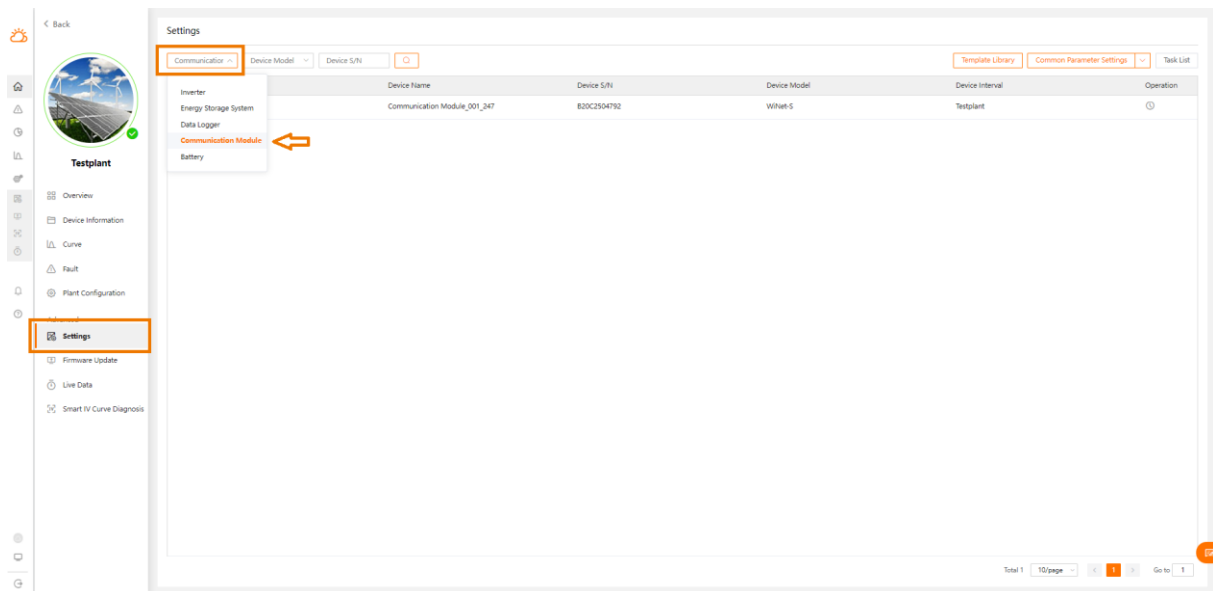

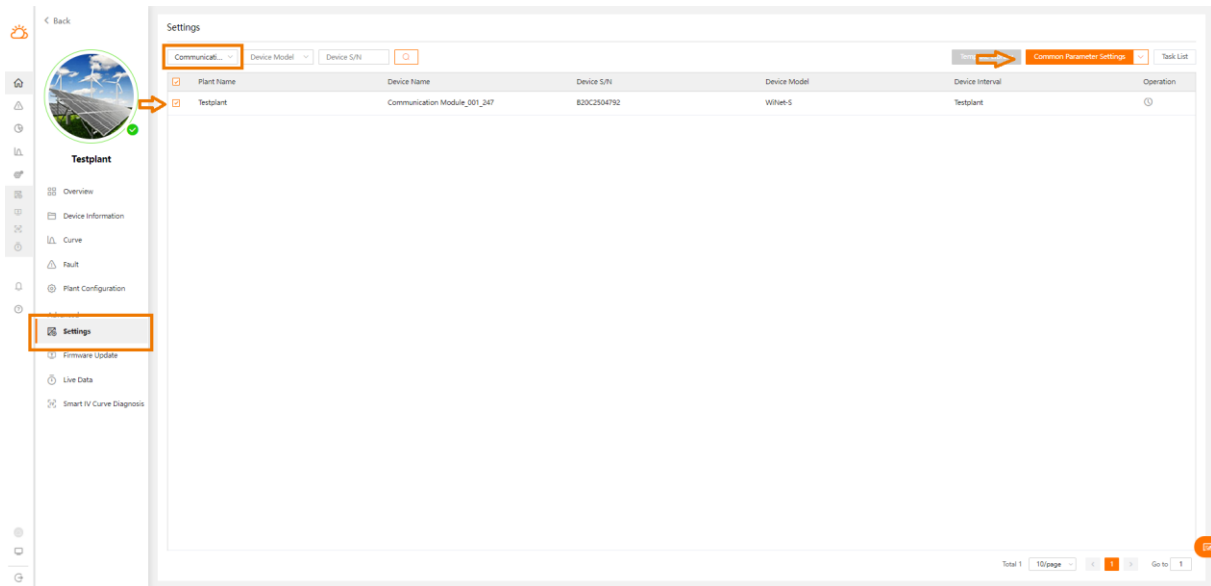

Find parameter **Cumulative daily usage of live data** and select **24**. Click **Apply Settings** and confirm with your password.

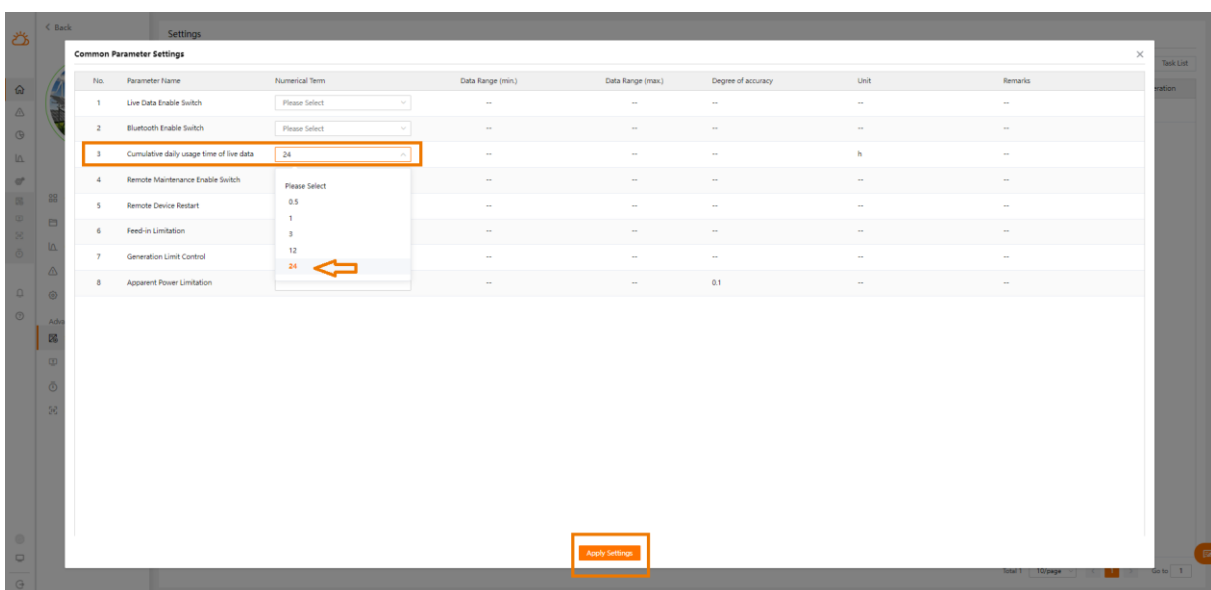

The screenshot displays the 'Settings' page in the Sungrow interface. A table titled 'Common Parameter Settings' is visible, listing various parameters. A dialog box is overlaid on the table, prompting the user to enter a login password. The dialog box has a title bar 'Please enter login password.', a text input field with masked characters, and a 'Confirm' button. An orange arrow points to the dialog box.

No.	Parameter Name	Numerical Term	Data Range (min.)	Data Range (max.)	Degree of accuracy	Limit	Remarks
1	Live Data Enable Switch	Please Select	--	--	--	--	--
2	Bluetooth Enable Switch	Please Select	--	--	--	--	--
3	Cumulative daily usage time of live data	24	--	--	--	h	--
4	Remote Maintenance Enable Switch	Please Select	--	--	--	--	--
5	Remote Device Restart	Please Select	--	--	--	--	--
6	Feed-in Limitation	Please Select	--	--	--	--	--
7	Generation Limit Control	Please Select	--	--	--	--	--
8	Apparent Power Limitation		--	--	0.1	--	--

On the iSolarCloud app first select the plant containing a WiNet-S module (WiNet-S is used as an example), then go to **Device** tab and select the WiNet-S module. Scroll to the right and select the last tab **Settings**.

Select **Common Parameters** and select **24** in the **Cumulative Daily Usage time of Live Data**. Select **Apply Settings** and confirm.

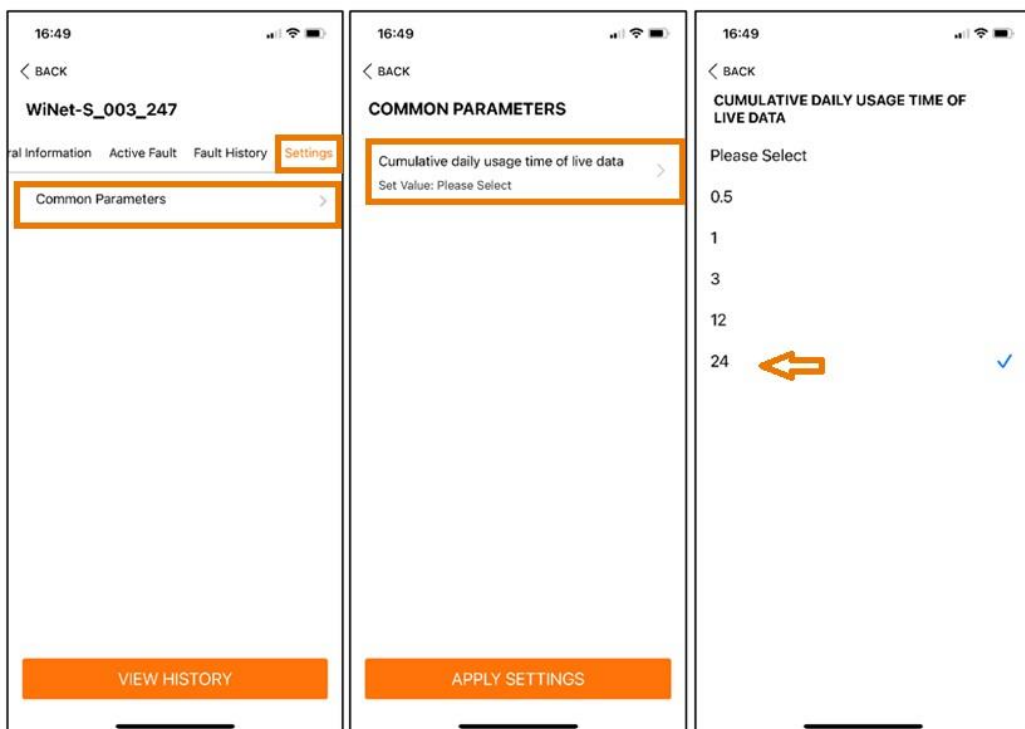
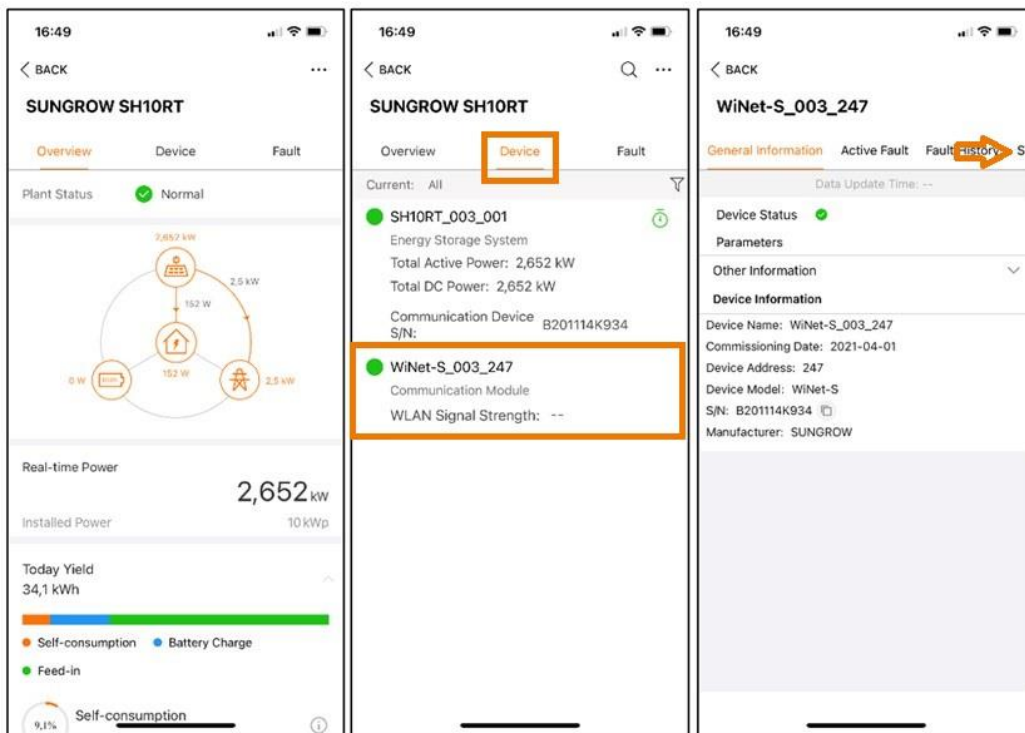

For further information, please download the user manual [here](#).

This manual is intended for professional technicians who are responsible for installation, operation, maintenance and troubleshooting of inverters, and users who need to check inverter parameters. The inverter must only be installed by professional technicians.

The professional technician is required to meet the following requirements:

- Know electronic, electrical wiring and mechanical expertise, and be familiar with electrical and mechanical schematics.
- Have received professional training related to the installation, commissioning and troubleshooting of electrical equipment.
- Be able to quickly respond to hazards or emergencies that occur during installation, commissioning and troubleshooting.
- Be familiar with local standards and relevant safety regulations of electrical systems.
- Read this manual thoroughly and understand the safety instructions related to operations.